

# QUICK START GUIDE

TUNE215 TWS



HARMAN

## WHAT'S IN THE BOX



## HOW TO WEAR

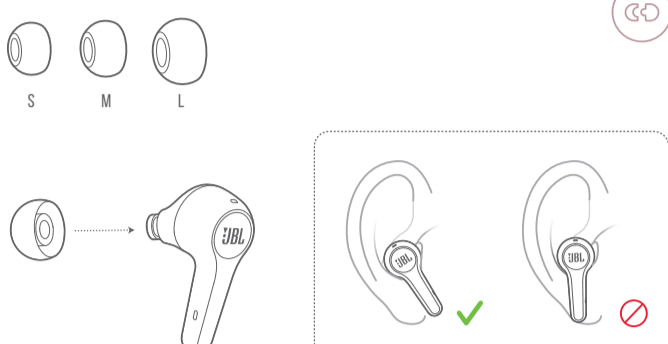

## FIRST TIME USE

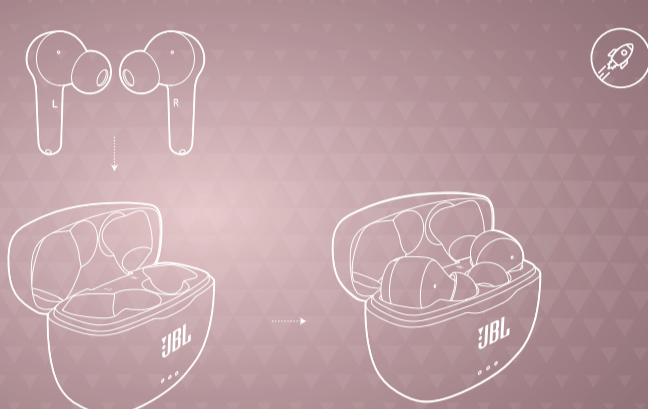

## POWER ON & CONNECT

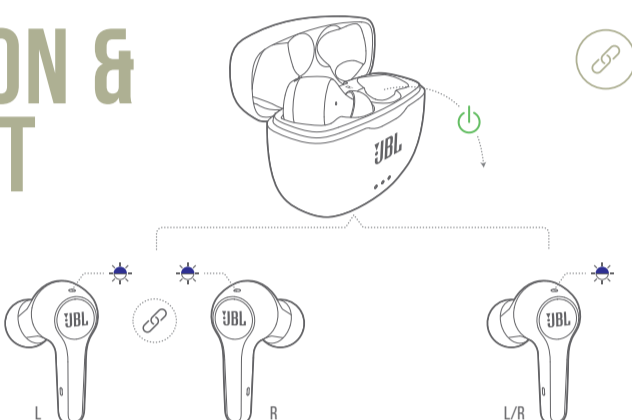

## PAIRING

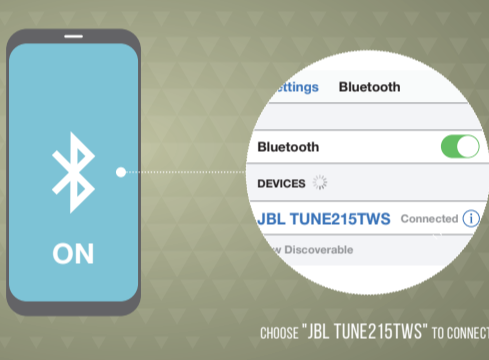

## POWER OFF

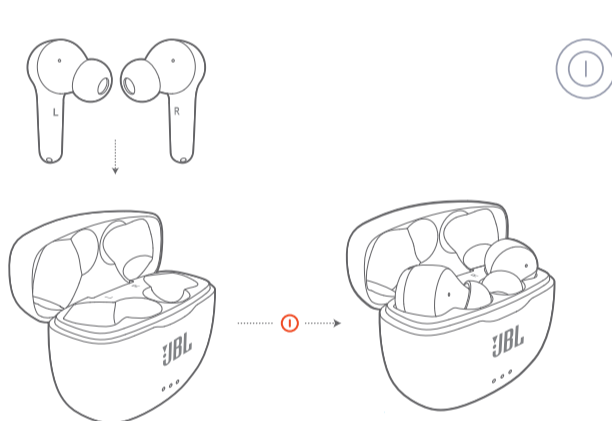

## MANUAL CONTROLS

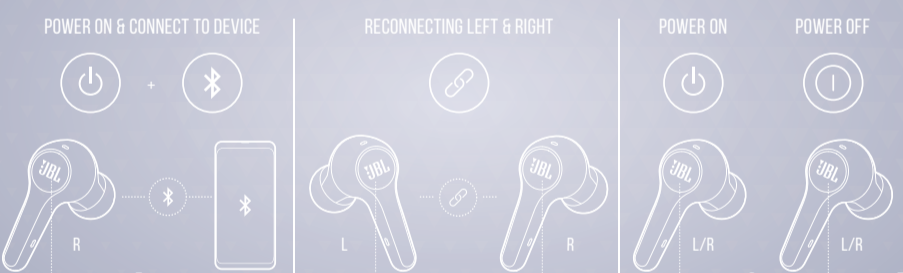

## BUTTON COMMAND

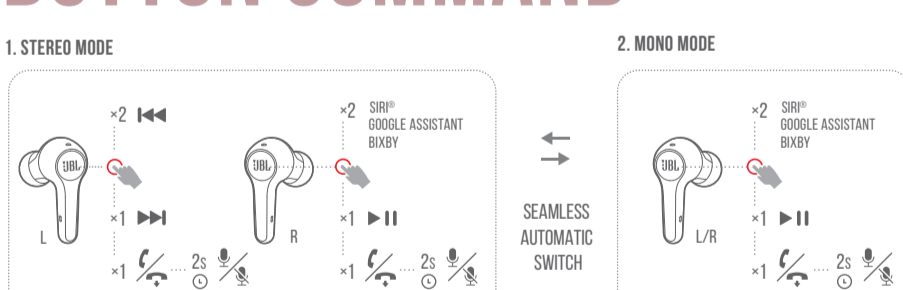

## CHARGING

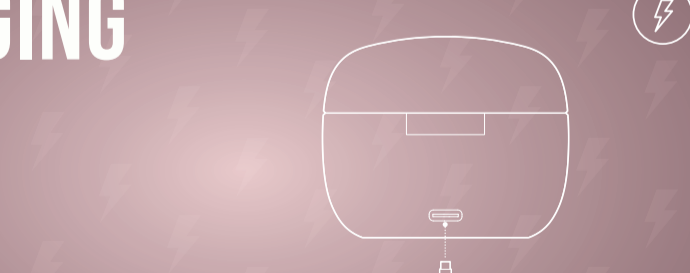

## LED BEHAVIORS

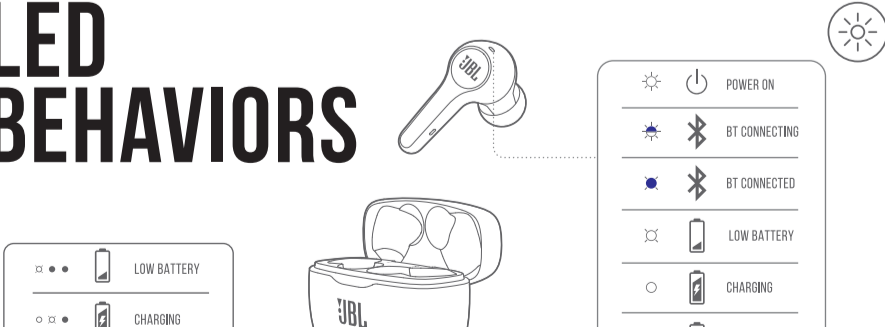

## TECH SPEC

Model:	TUNE215TWS
Driver size:	6.0 mm / 0.24" Dynamic driver
Power supply:	5V = 1 A
Weight:	62.1 g / 0.137 lbs
Earpiece:	5.4 g / 0.012 lbs / pc (10.8 g / 0.024 lbs combined)
Charging case:	51.3 g / 0.113 lbs
Headset battery type:	Lithium polymer Battery (55 mAh / 3.7 V)
Charging case battery type:	Lithium polymer Battery (660 mAh / 3.7 V)
Charging time:	< 2 hrs from empty
Music playtime with BT on:	5 hrs
Frequency Response:	20 Hz – 20 kHz
Impedance:	14 ohm
Sensitivity:	108 dB SPL@1 kHz / 1 mW
Maximum SPL:	95 dB
Microphone sensitivity:	-30 dBV / Pa@1 kHz
Bluetooth version:	5.0
Bluetooth profile version:	A2DP 1.3, AVRCP 1.6, HFP 1.7
Bluetooth transmitter frequency range:	2.4 GHz - 2.4835 GHz
Bluetooth transmitter power:	< 6 dbm
Bluetooth transmitter modulation:	GFSK, π/4 DQPSK, 8DPSK
Maximum operation temperature:	45 °C

